

URBAN RESIDENTIAL DRIVE DETAILS

803-2
REFERENCE SECTION
803.3 & 804.2

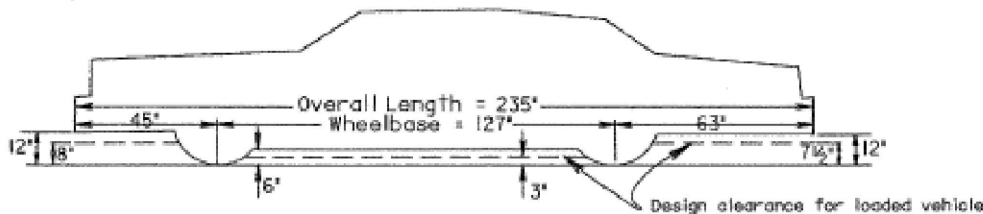

DESIGN VEHICLE

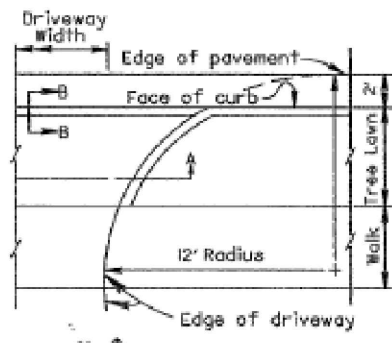

R = Tree Lawn width, 3' minimum
 L = Tree lawn width, 1'-6" min.

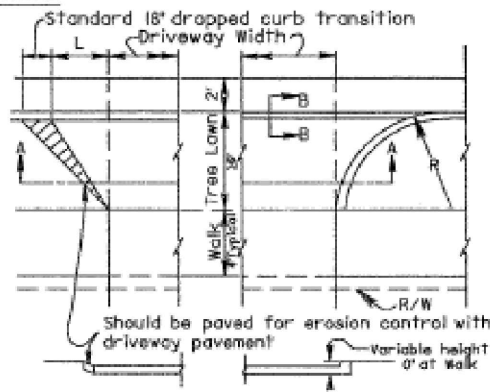

SECTION A-A

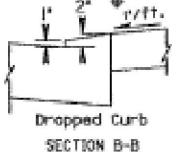

RESIDENTIAL DRIVEWAYS

(Plan view of three apron designs)

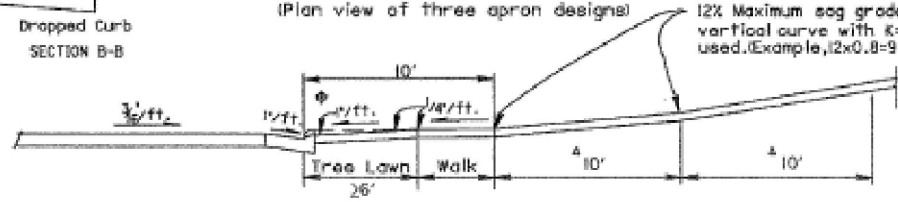

12% Maximum sag grade break. Sag vertical curve with $K=0.8$ may be used. (Example, 12x0.8=9.6' V.C.)

A Minimum grade length.
 ♦ Tree lawn >6' will have a flatter slope.

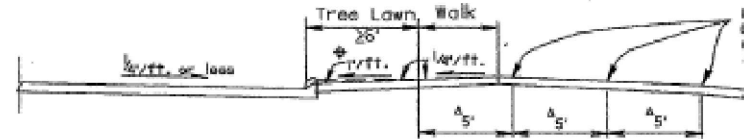
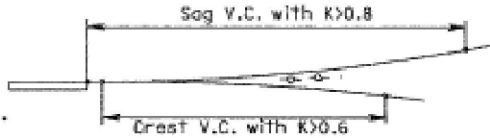

8% Maximum crest grade break
 Crest vertical curve with $K=0.6$ may be used. (Example, 8x0.6=4.8' vertical curve.)

RESIDENTIAL DRIVEWAY PROFILES
 6' OR GREATER TREE LAWN



STANDARD DETAIL
 URBAN RESIDENTIAL
 ODOT DRIVE DETAIL

S-2

REVISION
 12/13/2016
 CITY OF TWINSBURG
 ENGINEERING DEPARTMENT
 10075 TAVERNIA ROAD, TWINSBURG, OHIO 44177
 PHONE: (330) 933-1247 FAX: (330) 264-6251